



L.C. DEVELOPMENT S.A.



KALAMATA PORT SHOPPING CENTER

LOCATION: EVAGELISTRIAS, KAMVISSI
& SALAMINOS STR.

LOCATION OF CITY IN REFERENCE IN MAP OF GREECE



Kalamata is the second-largest city of the Peloponnese. It is one of the largest municipal cities of Greece with an infrastructure in all sectors similar to that of Athens and Thessaloniki.

The capital and chief port of the Messinia prefecture, is found 238 km southwest of Athens, about 60 km west of Sparta, and about 8 km east of Messene.

The 2001 census recorded a population of **57,620**.

Furthermore, the city has an international airport and is an important harbour both commercially and touristically.

KALAMATA PORT SHOPPING CENTER

LOCATION OF CITY IN REFERENCE INROAD MAP OF ADJACENT AREAS

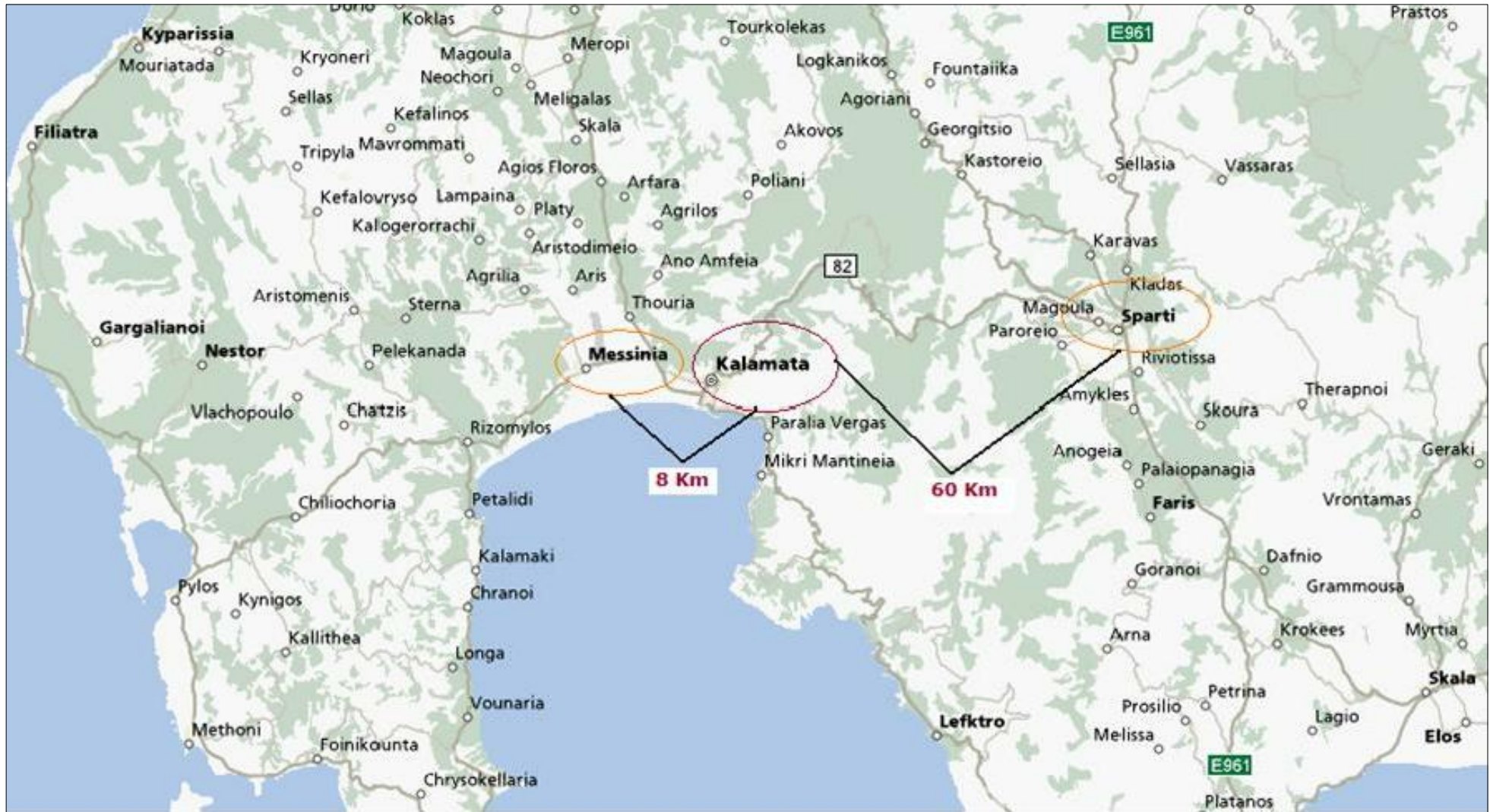

KALAMATA PORT SHOPPING CENTER

PLOT POSITION



KALAMATA PORT SHOPPING CENTER

PLOT AREA = 3275.22 m²		
TOTAL BUILDING AREA=5,895.4m²		
<i>LEVEL</i>	<i>USE</i>	<i>AREA</i>
GROUND LEVEL	SHOPPING	2,248 m²
1st FLOOR	OFFICE,HOUSING	2,001 m²
2nd FLOOR	HOUSING	1,040 m²

KALAMATA PORT SHOPPING CENTER

PROJECT DATA

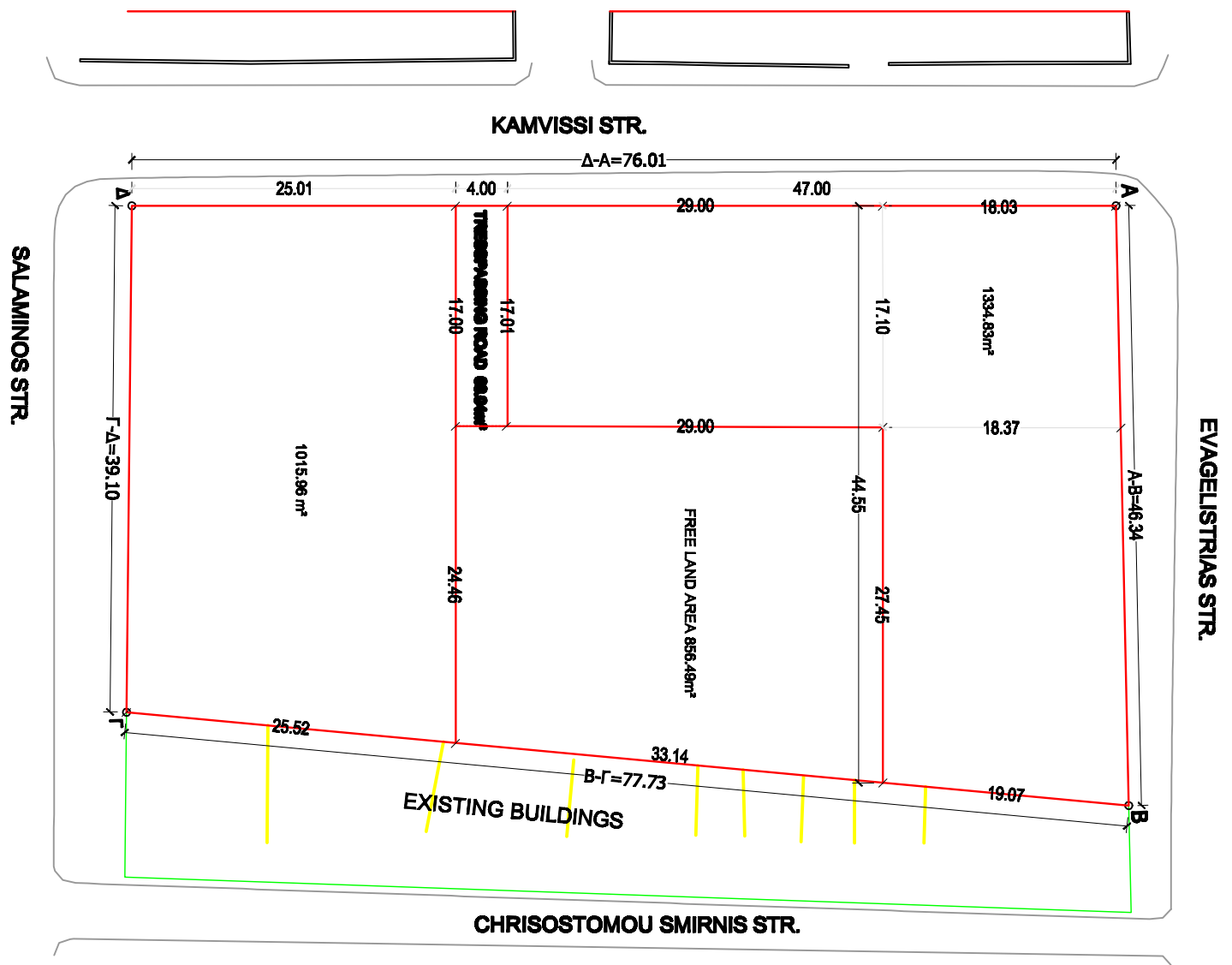

KALAMATA PORT SHOPPING CENTER
PLOT TOTAL SURFACE (ΑΒΓΔΑ) = 3275.22 τ.μ
BUILDING AREA = 5,895.39 m²
COVERAGE AREA = 2,292.65 m²

SCALE 1:500

SCALE 1:500

SALAMINOS STR.

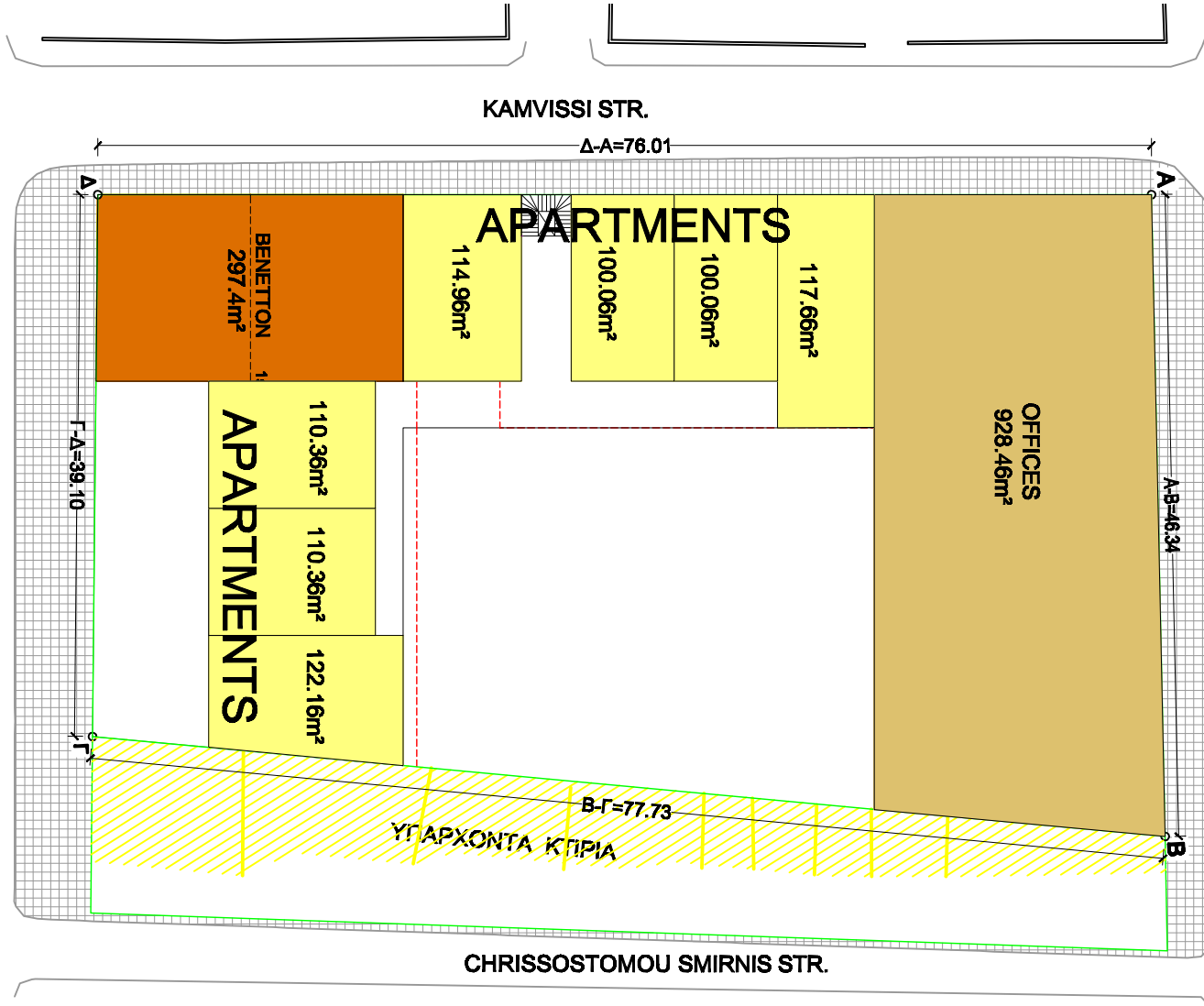

KALAMATA-PORT SHOPPING CENTER
1ST FLOOR LEVEL LAYOUT
OFFICE and HOUSING 2,001m²

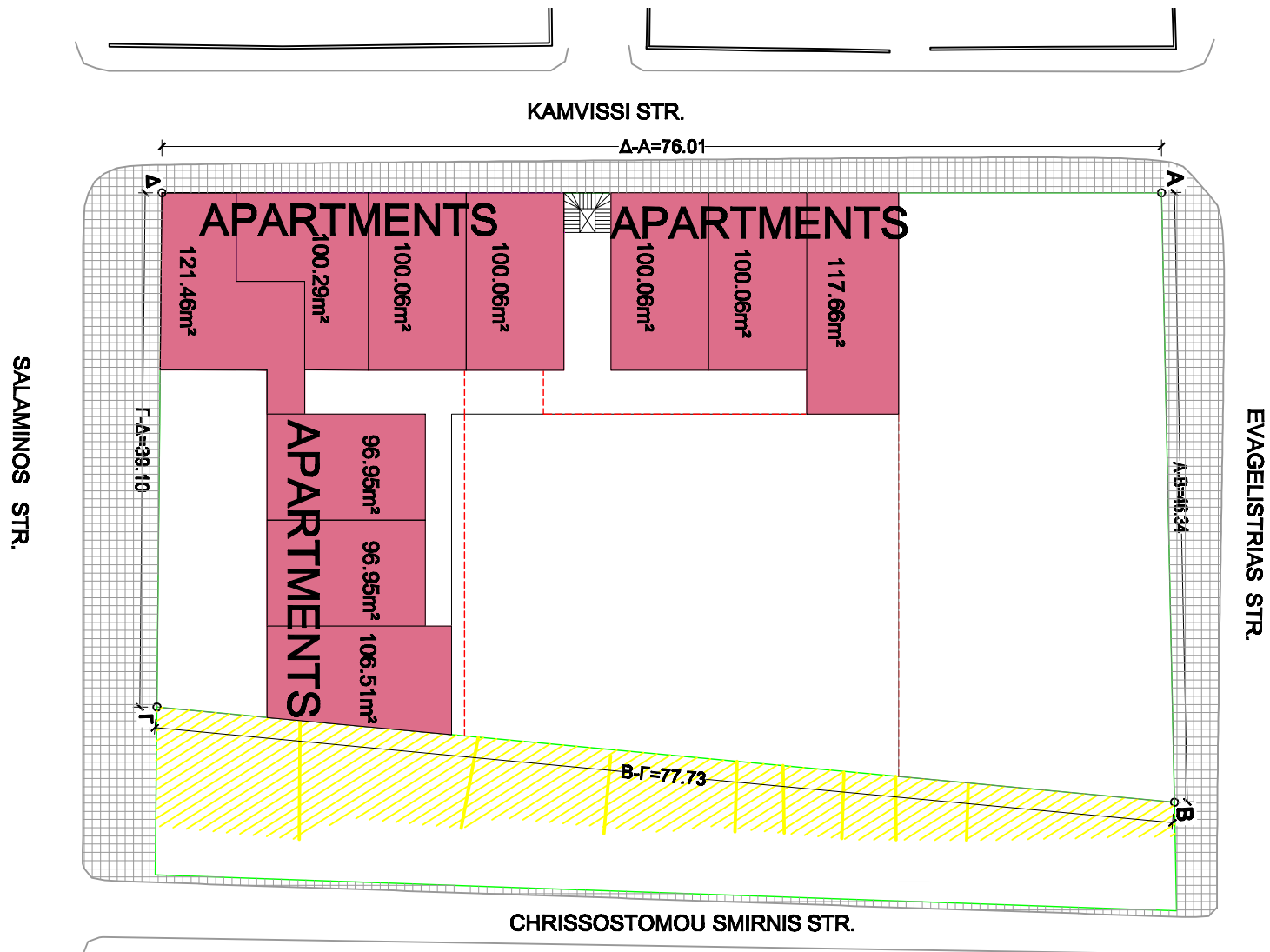

SCALE 1:500

KALAMATA PORT SHOPPING CENTER
2nd FLOOR LEVEL LAYOUT
HOUSING 1,040 m²

SALAMINOS STR.

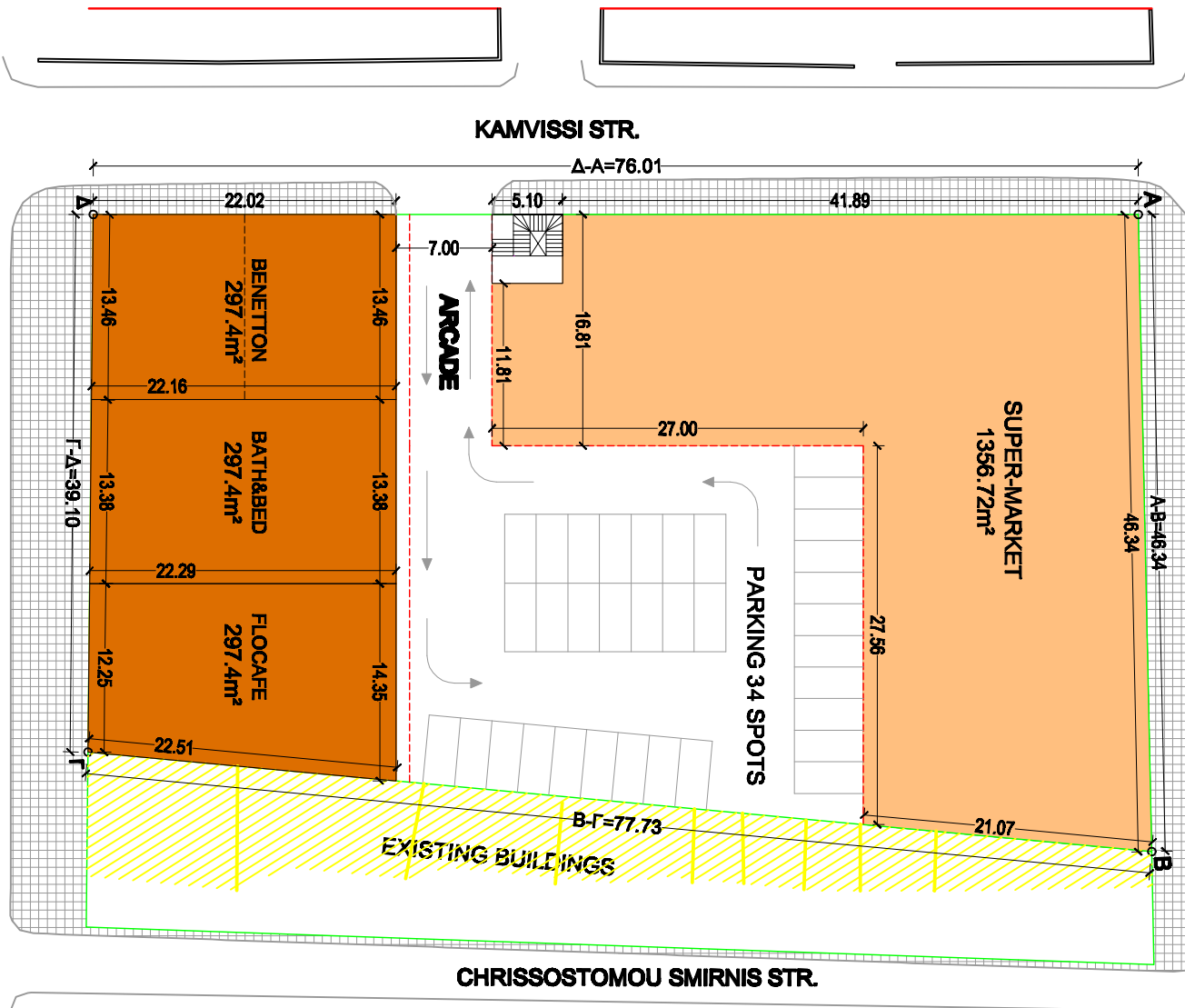

EVAGELISTRAS STR.

CHRISSOSTOMOU SMIRNIS STR.

KALAMATA-PORT SHOPPING CENTER GROUND LEVEL LAYOUT

SHOPPING 2,248 m²

SCALE 1:500